

SMITH & FRIENDS offer to the market this three bedroom terraced property situated in the popular TS4 area and offered with the benefit of NO CHAIN INVOLVED. The property would appeal to anyone looking to put their own stamp on it especially investors or first time buyers. The living accommodation briefly comprises; spacious lounge with stairs to the first floor, fitted kitchen, three first floor bedroom and a shower room/WC. To the rear of the property is a low maintenance yard with external outhouse and garden which is mainly laid to lawn to the front of the property.

Fremington Walk, Middlesbrough, TS4 3RD
3 Bed - House - Terraced
£75,000
EPC Rating: C
Council Tax Band:
Tenure: Freehold



**SMITH &
 FRIENDS**
 ESTATE AGENTS

Fremington Walk, Middlesbrough, TS4 3RD



Fremington Road
Approximate Gross Internal Area
818 sq ft - 76 sq m

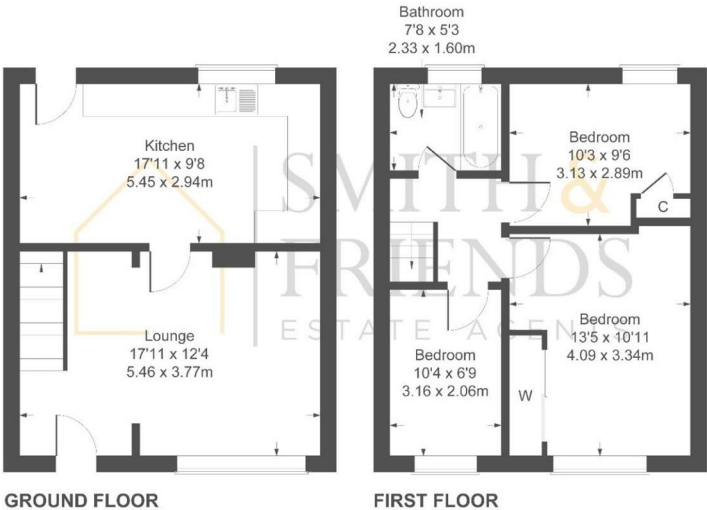

Not to Scale. Produced by The Plan Portal 2024
For Illustrative Purposes Only.

For clarification we wish to inform prospective purchasers that we have prepared these sales particulars as a general guide. We have not carried out a detailed survey, nor tested the services, appliances and specific fittings. Room sizes should not be relied upon for carpets and furnishings, if there are important matters which are likely to affect your decision to buy, please contact us before viewing the property. Smith & Friends Estate Agents can recommend financial services, surveying, conveyancing and removal services to sellers and buyers. Smith & Friends Estate Agents staff may benefit from referral incentives relating to these services.

Energy Efficiency Rating		
	Current	Potential
Very energy efficient - lower running costs		
(92 plus) A		87
(81-91) B		
(69-80) C	72	
(55-68) D		
(39-54) E		
(21-38) F		
(1-20) G		
Not energy efficient - higher running costs		
England & Wales		
EU Directive 2002/91/EC		

26 Stokesley Road, Marton, Middlesbrough,
TS7 8DX
01642 313666
middlesbrough@smith-and-friends.co.uk
www.smith-and-friends.co.uk



SMITH &
FRIENDS
ESTATE AGENTS