

METRIC

- LEGEND:
- st((d) steel rod found
 - st(p) steel rod placed
 - r radius
 - Ha. hectors
 - t tank access
 - vp vent pipe
 - bsw Bermuda stone wall

This plan prepared for legal purposes only. It is not to be used for construction / design purposes. It is to be used for reference only. It is not to be used for any other purpose. It is not to be used for any other purpose. It is not to be used for any other purpose.

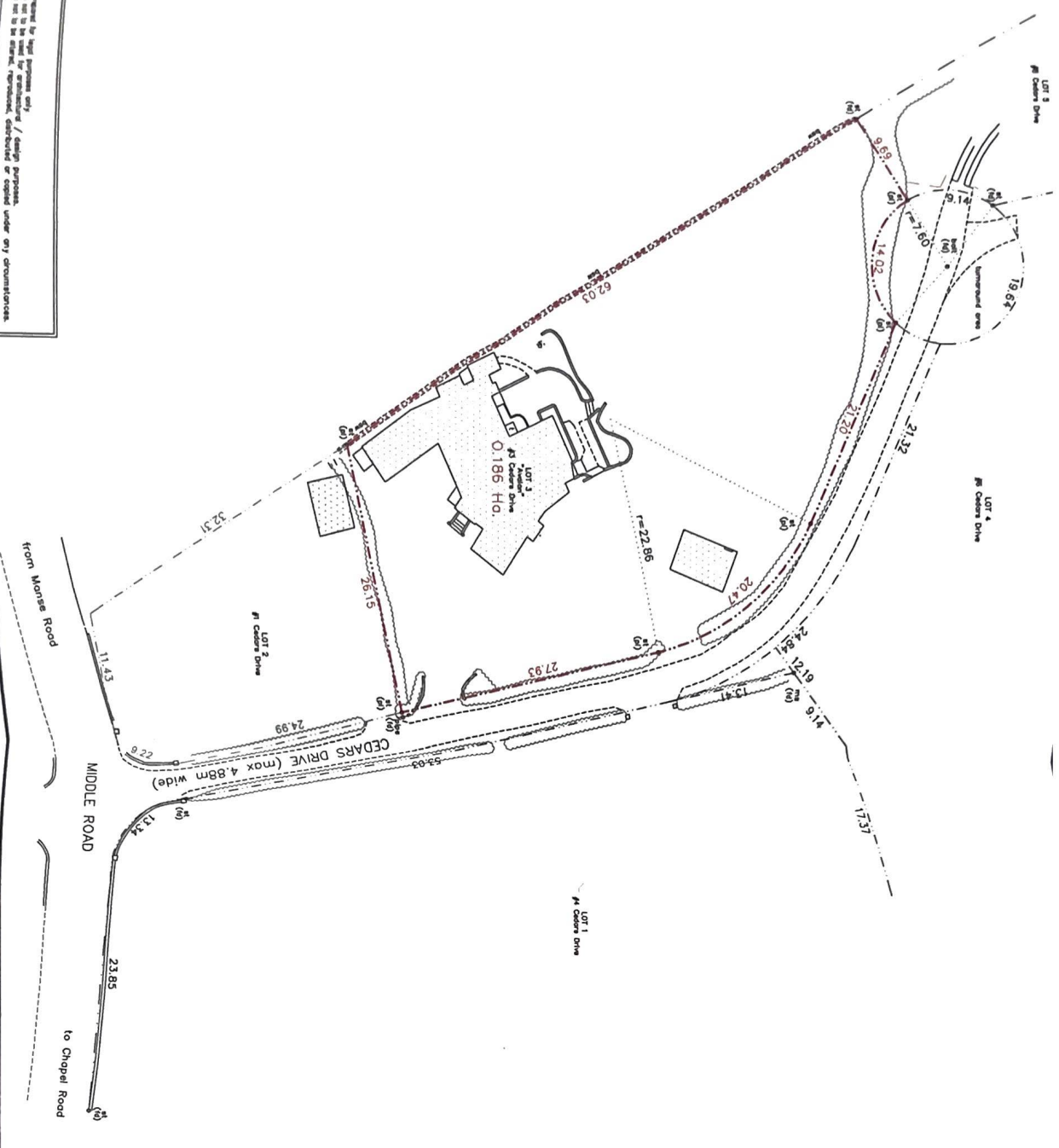

Riv	Date	Description

C.H.B. CRISSON LTD.
 Registered Land Surveyors
 Planning Consultants

Tel: (441) 285-0836
 Fax: (441) 285-2321
 e-mail: landsurvey@crissonvestatata.com

P. O. Box 11464
 Hamilton HM CX
 Bermuda

**TITLE PLAN OF LAND IN
 PAGET PARISH
 BERMUDA**

SCALE	1:400	DATE	OCT 2024
BNG	2000	DWG NO.	CS/1667
	546570 E 131152 N		

Incorporating land survey records of Robert H. Crisson, Gouffier and Jones Ltd., P.A.O. Smith, Thomas & Associates Ltd., and Crisson, Gouffier and Jones Ltd. (Jointly Chartered Land) Surveyors and Surveying Services Limited.

STATE OF
J.M. PATTON

E. J. Smith
Acting Colonial Secretary
13th September, 1954.

ESTATE OF HENRY LOCKWARD

ANNEX A

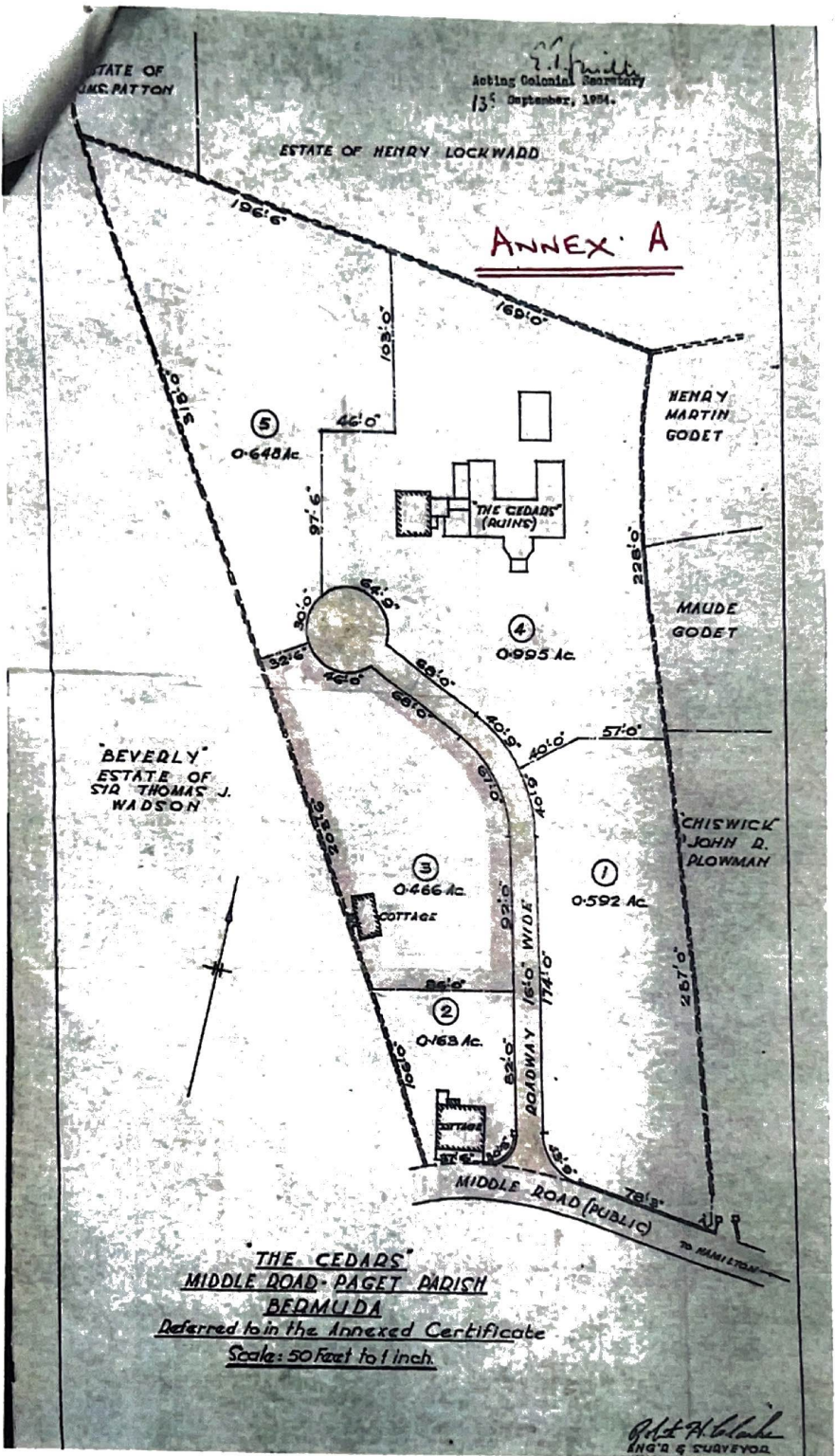

BEVERLY
ESTATE OF
SIR THOMAS J.
WADSON

HENRY
MARTIN
GODET

MAUDE
GODET

CHISWICK
JOHN D.
PLOWMAN

THE CEDARS
MIDDLE ROAD - PAGET PARISH
BERMUDA
Referred to in the Annexed Certificate
Scale: 50 feet to 1 inch.

R. H. A. ...
ENG'G & SURVEYOR

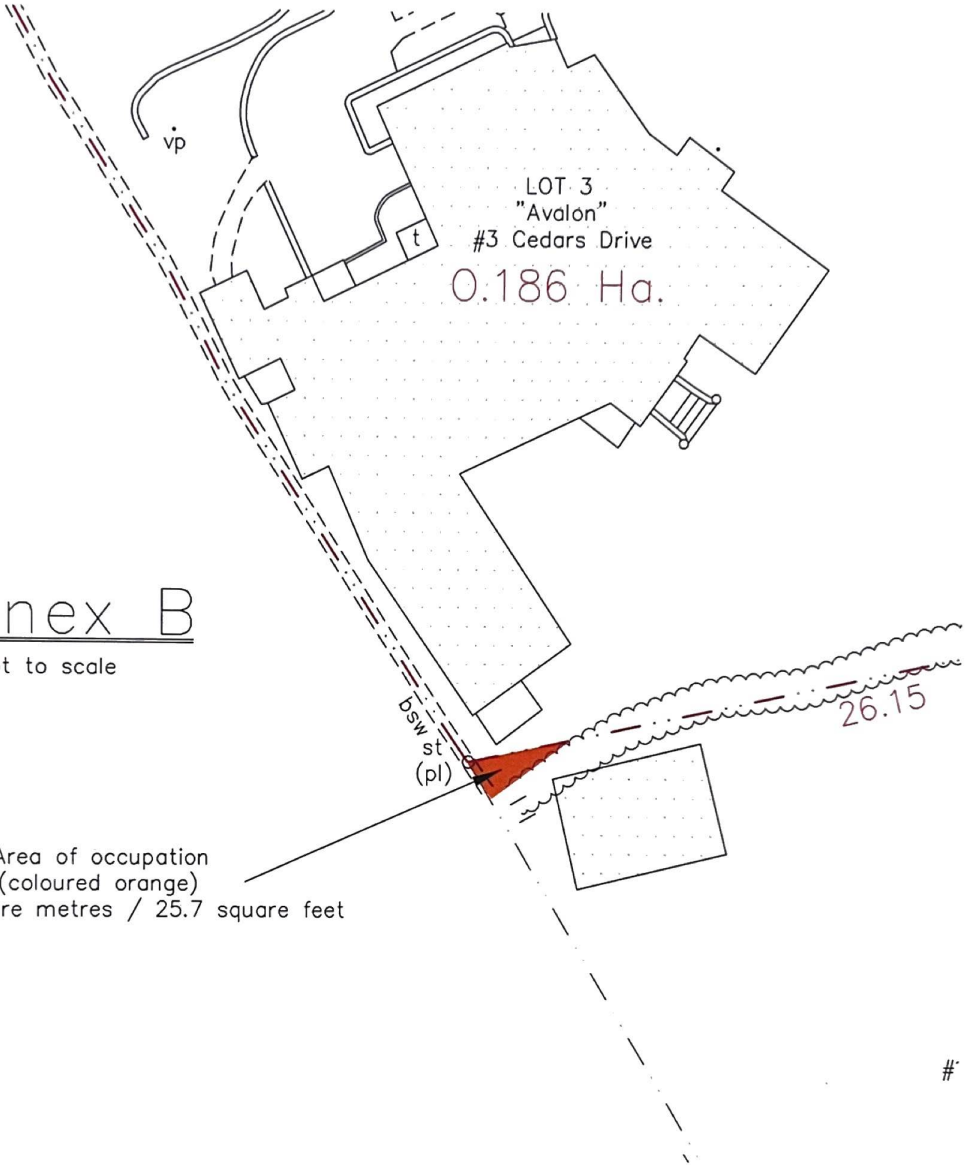

LOT 3
"Avalon"
#3 Cedars Drive
0.186 Ha.

Annex B
not to scale

Area of occupation
(coloured orange)
2.39 square metres / 25.7 square feet

#