



BaBa

BEACH CLUB

NATAI

5-Bedroom Beachfront Villa

Baba Beachfront Villa, The oversized and architecturally refined five-bedroom Baba Beachfront Villa is the place for the discerning few. At your doorstep, the gentle rolling waves break on the golden sands of Natai Beach, leading up to green lawns and tropical gardens that make your Baba Beachfront Villa feel like a private paradise.

PRICE @ 180 MB

Price are subject to change without prior notice



5 BEDROOM BEACHFRONT VILLAS

Baba Beach Club Private Residence

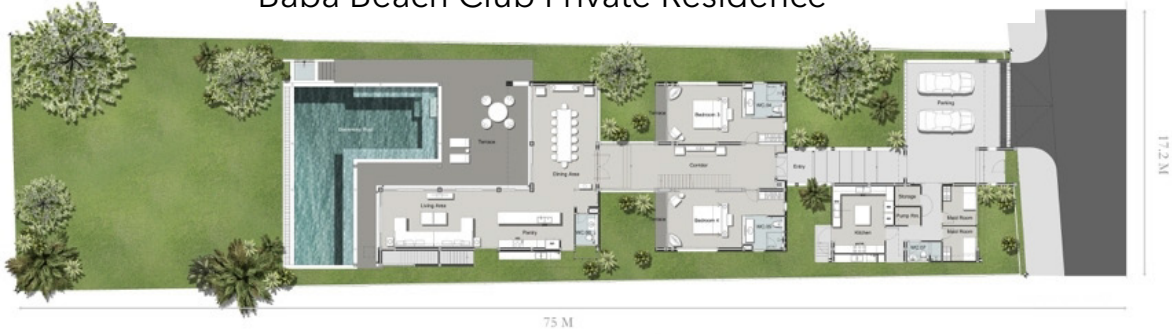

Swimming Pool	119 Sq.m.	Kitchen	27 Sq.m.	Dining & Living Room	114 Sq.m.
Pool Deck	107 Sq.m.	Maid BR 1	8.8 Sq.m.	Powder Room	5.7 Sq.m.
Hallway & Gate	50 Sq.m.	Maid BR 2	7.7 Sq.m.	Bedroom 3	34.5 Sq.m.
Parking	54 Sq.m.	Maid Bathroom	4.8 Sq.m.	Bathroom 3	8.9 Sq.m.
Hall Entrance	49.7 Sq.m.	Circulation	29.3 Sq.m.	Bedroom 4	34.3 Sq.m.
				Bathroom 4	8.9 Sq.m.

1st floor
Approx. Area 1,053 Sq.m.



Master Bedroom	72.2 Sq.m.	Bedroom 2	34.3 Sq.m.
Master Bathroom	19.6 Sq.m.	Bathroom 2	8.9 Sq.m.
Balcony	8.7 Sq.m.	Hall	34.2 Sq.m.
Bedroom 1	34.5 Sq.m.	Sunbathing Deck	70 Sq.m.
Bathroom 1	8.9 Sq.m.		

2nd floor
Approx. Area 1,053 sq.m.

FACILITIES & SERVICES

- Beach Club
- Restaurant & Bar
- Spa & Fitness
- Baba Boutique
- Tropical Lagoon Water Garden
- Swimming pool
- Kids' Swimming Pool
- Housekeeping & Maintenance Service
- 24 hrs. Reception and Security Service
- Car-Parking Area
- Off-site activities

Located just 20 minutes north of Phuket International Airport, Baba Beach Club is surrounded by a lush tropical environment in an area of rich natural beauty and unforgettable charm which is emerging as a prime extension of Phuket.

